



KEY

-  Detour Route
-  Road Closed



NTS

NOTES:
 TRAFFIC SHALL BE DETOURED PER THIS DETAIL ONLY WHEN SOUTH SPAN REPAIR WORK OCCURS OVER THE EXISTING STONEYBROOK W. PARKWAY EAST MOVEMENT.
 NO OTHER SIDE STREETS SHALL BE CLOSED WHEN THIS DETOUR IS IN EFFECT.
 DETOURS SHALL BE IN EFFECT ONLY DURING LANE CLOSURE TIMES.

CLOSE EB STONEYBROOK W PKWY PER PHASES 1 AND 2 OF THE STONEYBROOK W. PKWY TTC PLAN DETAILS.

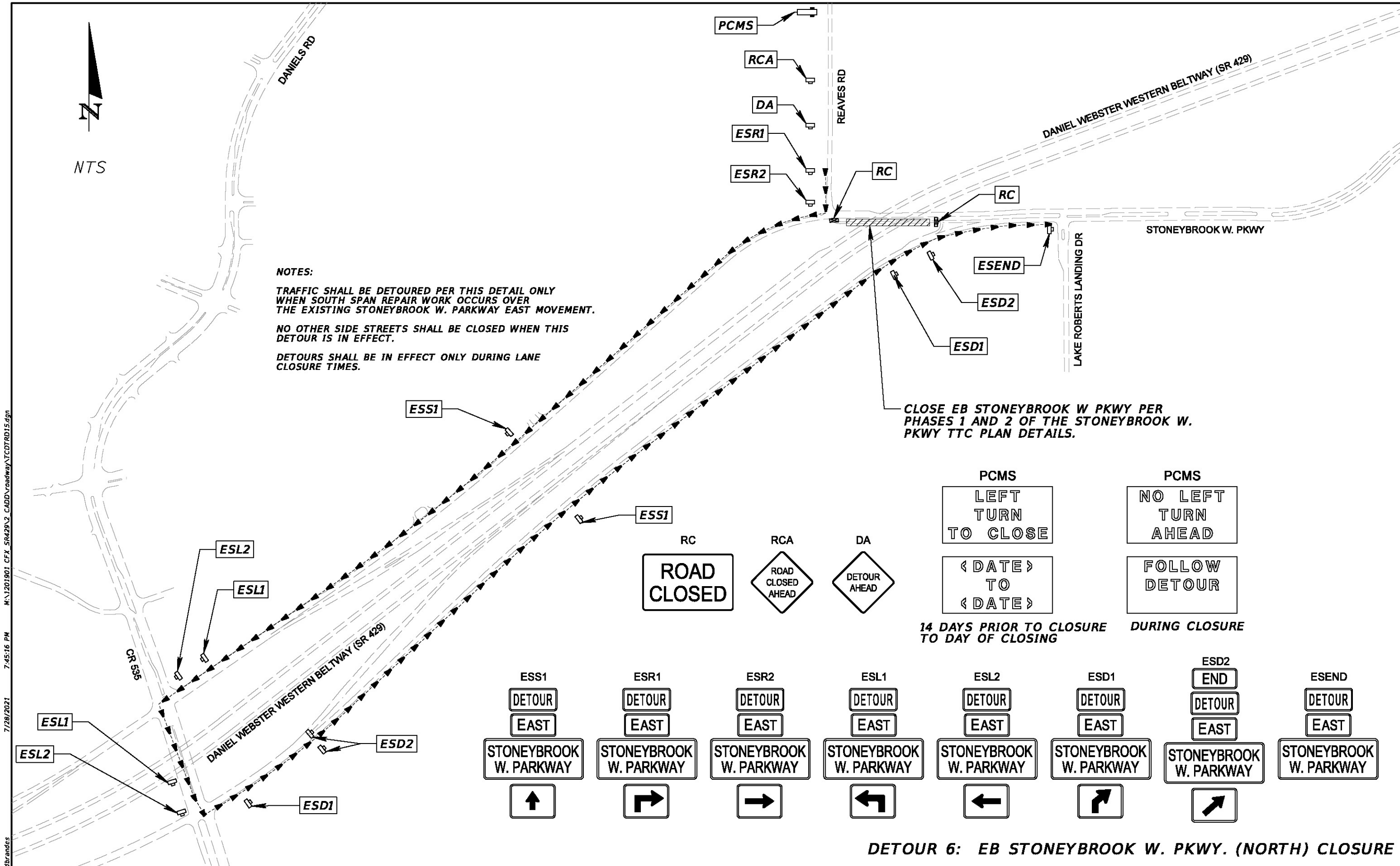

RC	RCA	DA	PCMS	PCMS			
ROAD CLOSED	ROAD CLOSED AHEAD	DETOUR AHEAD	LEFT TURN TO CLOSE	NO LEFT TURN AHEAD			
			< DATE > TO < DATE >	FOLLOW DETOUR			
			14 DAYS PRIOR TO CLOSURE TO DAY OF CLOSING	DURING CLOSURE			
ESS1	ESR1	ESR2	ESL1	ESL2	ESD1	ESD2	ESEND
DETOUR	DETOUR	DETOUR	DETOUR	DETOUR	DETOUR	DETOUR	DETOUR
EAST	EAST	EAST	EAST	EAST	EAST	EAST	EAST
STONEYBROOK W. PARKWAY	STONEYBROOK W. PARKWAY	STONEYBROOK W. PARKWAY	STONEYBROOK W. PARKWAY	STONEYBROOK W. PARKWAY	STONEYBROOK W. PARKWAY	STONEYBROOK W. PARKWAY	STONEYBROOK W. PARKWAY
↑	↗	→	↖	←	↗	↗	↗

DETOUR 6: EB STONEYBROOK W. PKWY. (NORTH) CLOSURE

REVISIONS				ENGINEER OF RECORD: DARREN BRANDES, PE P.E. LICENSE NUMBER 53982 KISINGER CAMPO & ASSOCIATES CORP. 111 N. MAGNOLIA AVE., SUITE 1050 ORLANDO, FL 32801	SR 429 WIDENING FROM TILDEN ROAD TO FLORIDA'S TURNPIKE		CENTRAL FLORIDA EXPRESSWAY AUTHORITY	TTC PLANS	SHEET NO. 499
DATE	DESCRIPTION	DATE	DESCRIPTION		ROAD NO. SR 429	PROJECT NO. 429-154			

7/28/2021 7:45:16 PM M:\1201501_CFX_SR429\2_CADD\roadway\TCDTRD15.dgn dbrandes

THE OFFICIAL RECORD OF THIS SHEET IS THE ELECTRONIC FILE DIGITALLY SIGNED AND SEALED UNDER RULE 61G15-23.004, F.A.C.